

LOCKDOWN ALERT SYSTEM TRANSCIEVER

PRESENTATION

- Connected to the master clock by its external input or by a 3 input expansion card, the GSM control allows you to control audio systems (Harmonys or Melodys or Sigma Sound) for time signals and Lockdown Alert System alerts.
- Up to 48 remote control can be paired with the receiver.
- 1 km free space signal coverage.
- Coverage inside buildings is limited by the structure and number of walls that the radio signal must pass through.
- LoRa technology.
- This device cannot be the only means of triggering an alarm. A wired solution must be present on the site.



STANDARDS

RED 2014/53/EU directive

- EN 301-489-3
- EN 300-220-2

REMOTE CONTROL

TECHNICAL CHARACTERISTICS

- **LED indicator**..... Bi-colour LED green for transmission and orange to confirm that the receiver has received the command.
If the battery is low: The LED is red for transmission and confirmation.
- **Number of keys**..... 4 keys to control up to 4 relays (configuration of DIPs for common or independent controls between the relays).

MECHANICAL FEATURES

- **Construction**..... Black casing.
- **Operating temperature**..... -20° to +70°C.

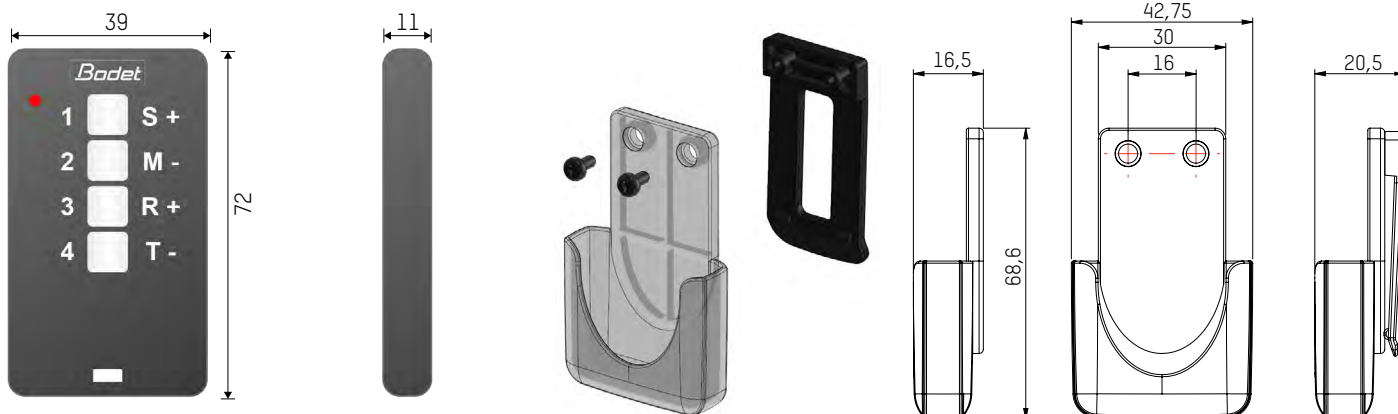

Dimensions in mm

ELECTRICAL CHARACTERISTICS

- **Battery powered**..... 3V (CR2032 lithium battery).
- **Typical usage**..... Transmission: 35 mA.
Acknowledgement: 16 mA.
- **Strength of output signal**..... 10 mW.
- **Frequency**..... 868.30 MHz.



LOCKDOWN ALERT SYSTEM TRANSCIEVER

RECEIVER

TECHNICAL CHARACTERISTICS

- **Wiring**..... 2 cables:
1 x 2 pair cable for the power supply and common control of the relays.
1 x 3 pair cable for the independent control of the relays.

MECHANICAL FEATURES

- **Construction**..... Grey ABS casing RAL 7035.
- **Operating temperature**..... 0°C +50°C.
- **Protection class**..... IP56, IK08.
- **Weight**..... 0.6 kg.
- **Dimensions**..... See opposite.

Dimensions in mm

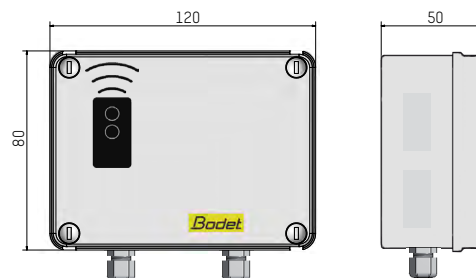

ELECTRICAL CHARACTERISTICS

- **Power supply**..... 12V (from the GPS input or DHF of the master clock) or 24V (from the impulse output of the master clock).
- **Reception sensitivity**..... -122 dBm.

REMOTE CONTROL + RECEIVER

REFERENCES

- 907 542..... 3 input expansion card for the Sigma master clock.
- 907 552..... Lockdown Alert System remote control + receiver.
- 907 553..... Lockdown Alert System remote control.
- 907 554..... Support clip for LoRa remote control.

SYNOPTIC

LOCKDOWN ALERT SYSTEM TRANSCIEVER (REF.: 907 552)

